

CORNER RECORD

Agency Index: CR-24-355

Document Number: _____

City of STOCKTON County of SAN JOAQUIN, California

Brief Legal Description MONUMENT ON THE SOUTHERLY SIDE OF CASTLE STREET AT BONNIE LANE.

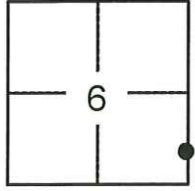

C.M. WEBER GRANT

CORNER TYPE

- Government Corner
- Meander
- Rancho
- Control
- Property
- Other

Date of Survey 08-14-2024

COORDINATES (Optional)

- N. _____ E. _____
- Elevation _____
- Units Metric U.S. Survey Foot
- Horizontal Datum _____
- Zone _____ Epoch Date _____
- Vertical Datum _____
- Complies with Public Resources Code SS8801-8819
- Complies with Public Resources Code SS8890-8902

PLS Act Ref: 8765(d) 8771 8773 Other: _____

Corner/
Monument: Left as found Established Rebuilt Pre-Construction
 Found and Tagged Reestablished Referenced Post-Construction

Narrative of corner identified and monument as found, set, reset, replaced, or removed:

See sheet #2 for description(s):

FOUND FOUR (4) CONCRETE NAILS WITH BRASS TAGS, MARKED "L.S. 6953", AS WITNESS CORNERS PER (R1);
SET ONE (1) CONCRETE NAIL WITH BRASS TAGS, MARKED "L.S. 6953", AS 3' WITNESS CORNER. ALL AS
SHOWN ON PAGE 2.

SURVEYOR'S STATEMENT

This Corner Record was prepared by me or under my direction in conformance with the Land Surveyors' Act on AUGUST 15, 2024,

Signed [Signature] P.L.S. or R.C.E. Number 6953



COUNTY SURVEYOR'S STATEMENT

This Corner Record was received September 23, 2024
and examined and filed October 10, 2024

Signed James E. Hart P.L.S. or R.C.E. No: 8657
Title County Surveyor



County Surveyor's Comment _____

LEGEND:

- ⊗ SET CONCRETE NAIL W/ BRASS TAGS MARKED "L.S. 6953"
- FOUND CONCRETE NAILS W/ BRASS TAGS MARKED "L.S. 6953" PER (R1)
- S.J.C.S.R. DENOTES SAN JOAQUIN COUNTY SURVEYOR'S RECORDS
- (M) MEASURED DISTANCE. ALL DISTANCES ARE MEASURED UNLESS OTHERWISE NOTED.
- CR CORNER RECORD, SAN JOAQUIN COUNTY SURVEYOR'S RECORDS

REFERENCE:

(R1) CR-24-308, S.J.C.S.R.

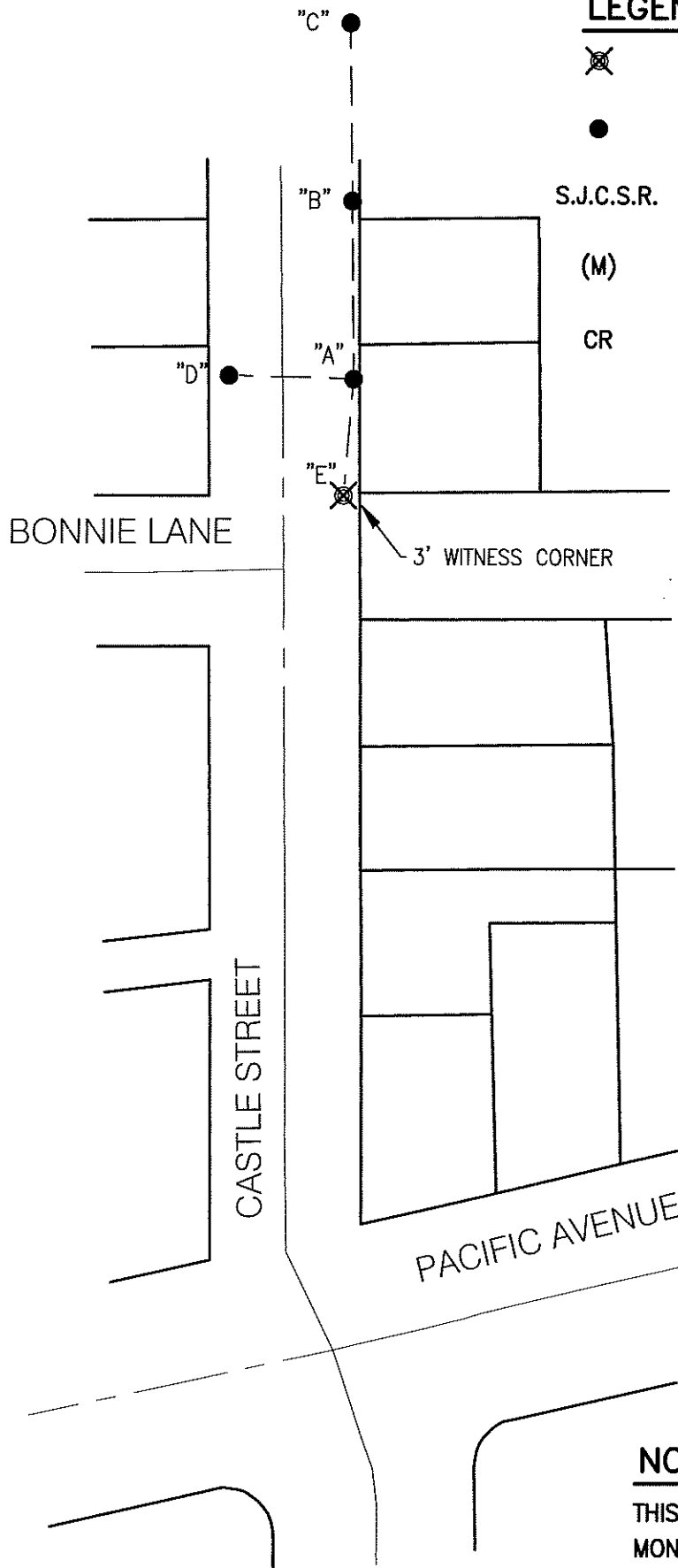

⊗ AND DISTANCE TABLE		
BS-@-FS	⊗	FS DISTANCE
C-A-C	00°00'00"	139.61'(M)(R1)
C-A-B	00°02'37"	69.72'(M)(R1)
C-A-D	272°31'56"	48.95'(M)(R1)
C-A-E	185°32'28"	45.81'(M)(R1)

NOTE:

THIS CORNER RECORD DOES NOT VERIFY THIS MONUMENT TO BE IN THE CORRECT POSITION.