

# CORNER RECORD

Agency Index CR-24-323  
Document Number \_\_\_\_\_

City of \_\_\_\_\_ STOCKTON County of \_\_\_\_\_ SAN JOAQUIN \_\_\_\_\_, California

Brief Legal Description FOUND MONUMENTS NEAR THE SOUTH WEST CORNER OF CENTER STREET AND JEFFERSON STREET PER CORNER RECORD 24-118, SAN JOAQUIN COUNTY SURVEYOR'S RECORDS.

### CORNER TYPE

### COORDINATES (Optional)

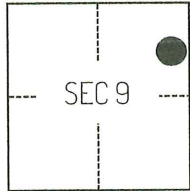

C.M. WEBER GRANT

- Government Corner
- Meander
- Rancho
- Control
- Property
- Other

Date of Survey February 10, 2023

N. \_\_\_\_\_ E. \_\_\_\_\_

Elevation \_\_\_\_\_

Units  Metric  U.S. Survey Foot

Horizontal Datum \_\_\_\_\_

Zone \_\_\_\_\_ Epoch Date \_\_\_\_\_

Vertical Datum \_\_\_\_\_

Complies with Public Resources Code §§8801-8819

Complies with Public Resources Code §§8890-8902

PLS Act Ref.:  8765(d)  8771  8773  Other:

Corner/Monument:  Left as found  Established  Rebuilt  Pre-Construction  
 Found and tagged  Reestablished  Referenced  Post-Construction

Narrative of corner identified and monument as found, set, reset, replaced, or removed:

See sheet #2 for description(s):

### SURVEYOR'S STATEMENT

This Corner Record was prepared by me or under my direction in conformance with the Professional Land Surveyors' Act on March 22, 2024

Signed Scott L. Blake P.L.S. or R.C.E. No. 8489



### COUNTY SURVEYOR'S STATEMENT

This Corner Record was received August 22, 2024 and examined and filed September 6, 2024

Signed James E. Hart P.L.S. or R.C.E. No. 8657

Title County Surveyor

County Surveyor's Comment \_\_\_\_\_



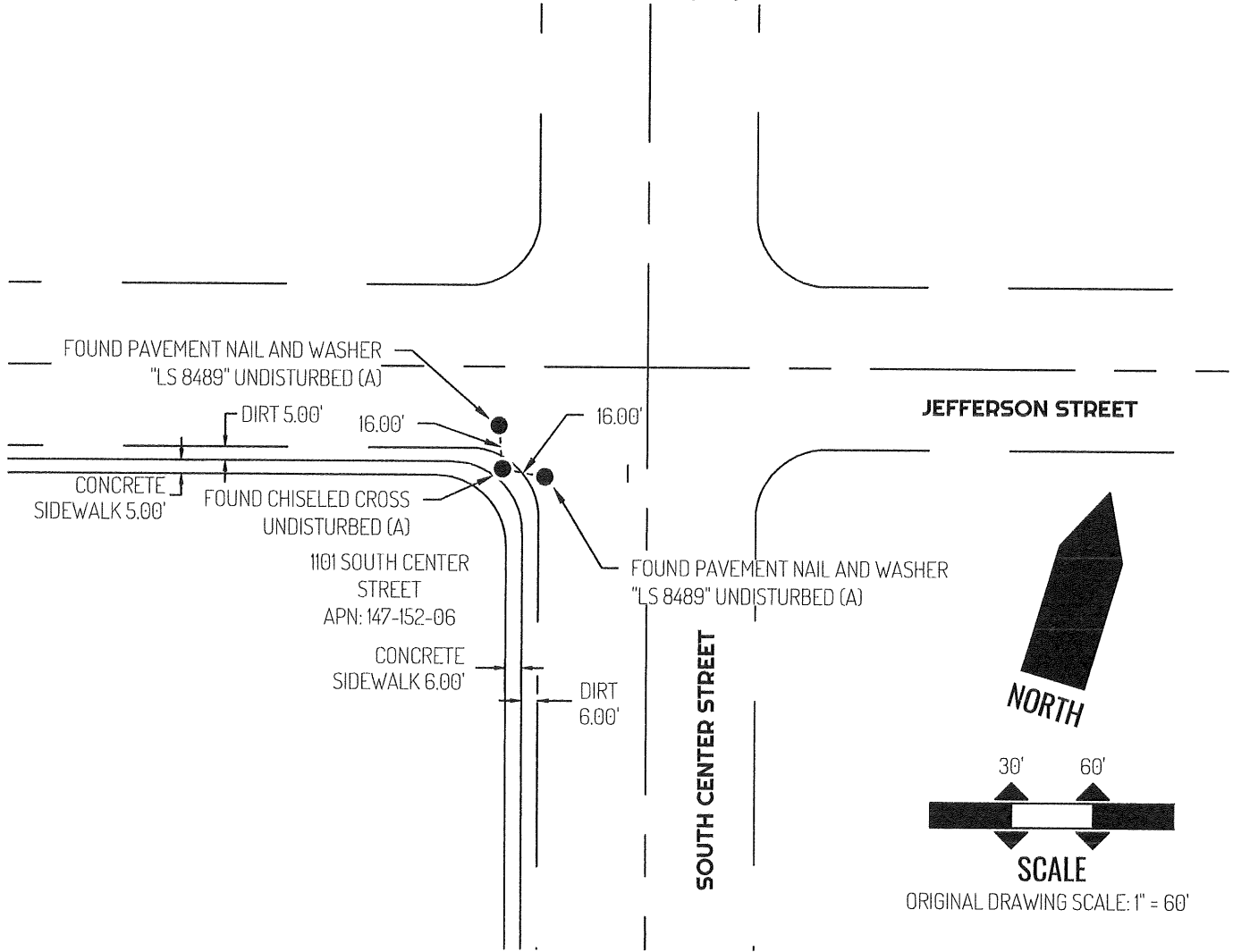

**LEGEND**

<p>●</p> <p>1101</p> <p>APN</p> <p>-----</p> <p>=====</p> <p>=====</p> <p>=====</p>	<p>FOUND MONUMENT AS NOTED</p> <p>REFERENCE STREET ADDRESS</p> <p>TAX ASSESSOR PARCEL NUMBER</p> <p>TIE LINE</p> <p>LOT LINE</p> <p>RIGHT-OF-WAY SIDELINE</p> <p>RIGHT-OF-WAY CENTERLINE</p>
---	--

**REFERENCE**

(A) CORNER RECORD 24-118, SAN JOAQUIN COUNTY SURVEYOR'S RECORDS