

# CORNER RECORD

Agency Index CR-24-280

Document Number \_\_\_\_\_

City of Stockton County of San Joaquin, California

Brief Legal Description CUT CROSS NE INTERSECTION N EL DORADO ST & EAST LINDSAY ST

### CORNER TYPE

### COORDINATES (Optional)

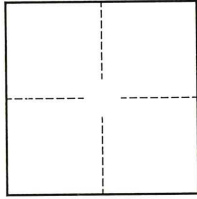

- Government Corner
- Meander
- Rancho
- Control
- Property
- Other

Date of Survey 2024-05-16

N. \_\_\_\_\_ E. \_\_\_\_\_

Elevation \_\_\_\_\_

Units  Metric  U.S. Survey Foot

Horizontal Datum \_\_\_\_\_

Zone \_\_\_\_\_ Epoch Date \_\_\_\_\_

Vertical Datum \_\_\_\_\_

Complies with Public Resources Code §§8801-8819

Complies with Public Resources Code §§8890-8902

PLS Act Ref.:  8765(d)  8771  8773  Other:

Corner/Monument:  Left as found  Established  Rebuilt  Pre-Construction

Found and tagged  Reestablished  Referenced  Post-Construction

Narrative of corner identified and monument as found, set, reset, replaced, or removed:

See sheet #2 for description(s):

### SURVEYOR'S STATEMENT

This Corner Record was prepared by me or under my direction in conformance with  
 the Professional Land Surveyors' Act on June 11th, 2024  
 Signed [Signature] P.L.S. or R.C.E. No. 8040

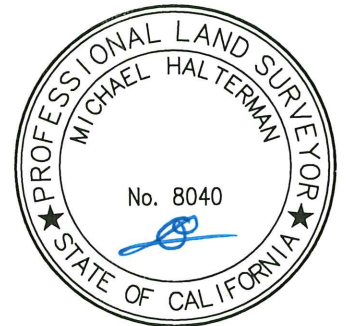

### COUNTY SURVEYOR'S STATEMENT

This Corner Record was received July 29, 2024  
 and examined and filed August 8, 2024  
 Signed [Signature] P.L.S. or R.C.E. No. 8657  
 Title County Surveyor  
 County Surveyor's Comment \_\_\_\_\_



LEGEND:

- FOUND CUT CROSS ON TOP OF CURB
- ⊕ SET CUT CROSS ON TOP OF CURB AS REFERENCE POINT

