

CORNER RECORD

Agency Index CR-24-284

Document Number _____

City of Stockton County of San Joaquin, California

Brief Legal Description CUT CROSS SE OF INTERSECTION OF EL DORADO & CHANNEL STREET ON CURB

CORNER TYPE

COORDINATES (Optional)

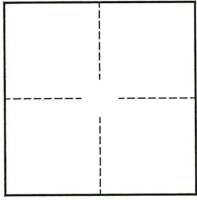

- Government Corner
- Meander
- Rancho
- Control
- Property
- Other

Date of Survey 2024-05-16

N. _____ E. _____

Elevation _____

Units Metric U.S. Survey Foot

Horizontal Datum _____

Zone _____ Epoch Date _____

Vertical Datum _____

Complies with Public Resources Code §§8801-8819

Complies with Public Resources Code §§8890-8902

PLS Act Ref.: 8765(d) 8771 8773 Other:

Corner/Monument: Left as found Established Rebuilt Pre-Construction

Found and tagged Reestablished Referenced Post-Construction

Narrative of corner identified and monument as found, set, reset, replaced, or removed:

See sheet #2 for description(s):

SURVEYOR'S STATEMENT

This Corner Record was prepared by me or under my direction in conformance with the Professional Land Surveyors' Act on June 4th, 2024

Signed [Signature] P.L.S. or R.C.E. No. 8040

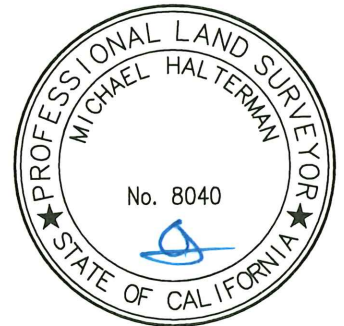

COUNTY SURVEYOR'S STATEMENT

This Corner Record was received July 29, 2024

and examined and filed August 8, 2024

Signed James E. Hart P.L.S. or R.C.E. No. 8657

Title County Surveyor

County Surveyor's Comment



LEGEND:

- FOUND CUT CROSS AS NOTED
- ⊕ SET CUT CROSS ON TOP OF CURB AS REFERENCE POINT
- ▲ FOUND 4" BRASS DISK W/
PUNCH "STEPHEN R.
THUMLERT MEMORIAL
MONUMENT 2003 PROPERTY
CORNER LS 4450 PLS 4334"

SCALE 1" = 40'



APN
139-100-01
31 E CHANNEL ST

APN
139-100-22
222 N EL DORADO ST

CHANNEL ST

APN
139-090-02
141 N EL DORADO ST

APN
139-110-01
130 N EL DORADO ST

