

CORNER RECORD

Agency Index CR-24-271

Document Number _____

City of STOCKTON County of SAN JOAQUIN, California

Brief Legal Description FOUND MONUMENTS AT THE INTERSECTION OF BAKER PLACE, KENSINGTON WAY, AND SOUTH TUXEDO AVENUE PER CORNER RECORD 22-230, SAN JOAQUIN COUNTY SURVEYOR'S RECORDS.

CORNER TYPE

COORDINATES (Optional)

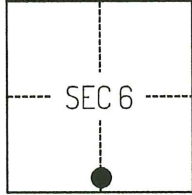

C.M. WEBER GRANT

- Government Corner Control
 Meander Property
 Rancho Other

Date of Survey March 8, 2022

N. _____ E. _____

Elevation _____

Units Metric U.S. Survey Foot

Horizontal Datum _____

Zone _____ Epoch Date _____

Vertical Datum _____

Complies with Public Resources Code §§8801-8819

Complies with Public Resources Code §§8890-8902

PLS Act Ref.:

8765(d)

8771

8773

Other:

Corner/
Monument:

Left as found

Established

Rebuilt

Pre-Construction

Found and tagged

Reestablished

Referenced

Post-Construction

Narrative of corner identified and monument as found, set, reset, replaced, or removed:

See sheet #2 for description(s):

SURVEYOR'S STATEMENT

This Corner Record was prepared by me or under my direction in conformance with

the Professional Land Surveyors' Act on March 12, 2024

Signed Scott L. Blake P.L.S. or R.C.E. No. 8489



COUNTY SURVEYOR'S STATEMENT

This Corner Record was received July 2, 2024

and examined and filed August 8, 2024

Signed James E. Hart P.L.S. or R.C.E. No. 8657

Title County Surveyor

County Surveyor's Comment



SOUTH TUXEDO AVENUE

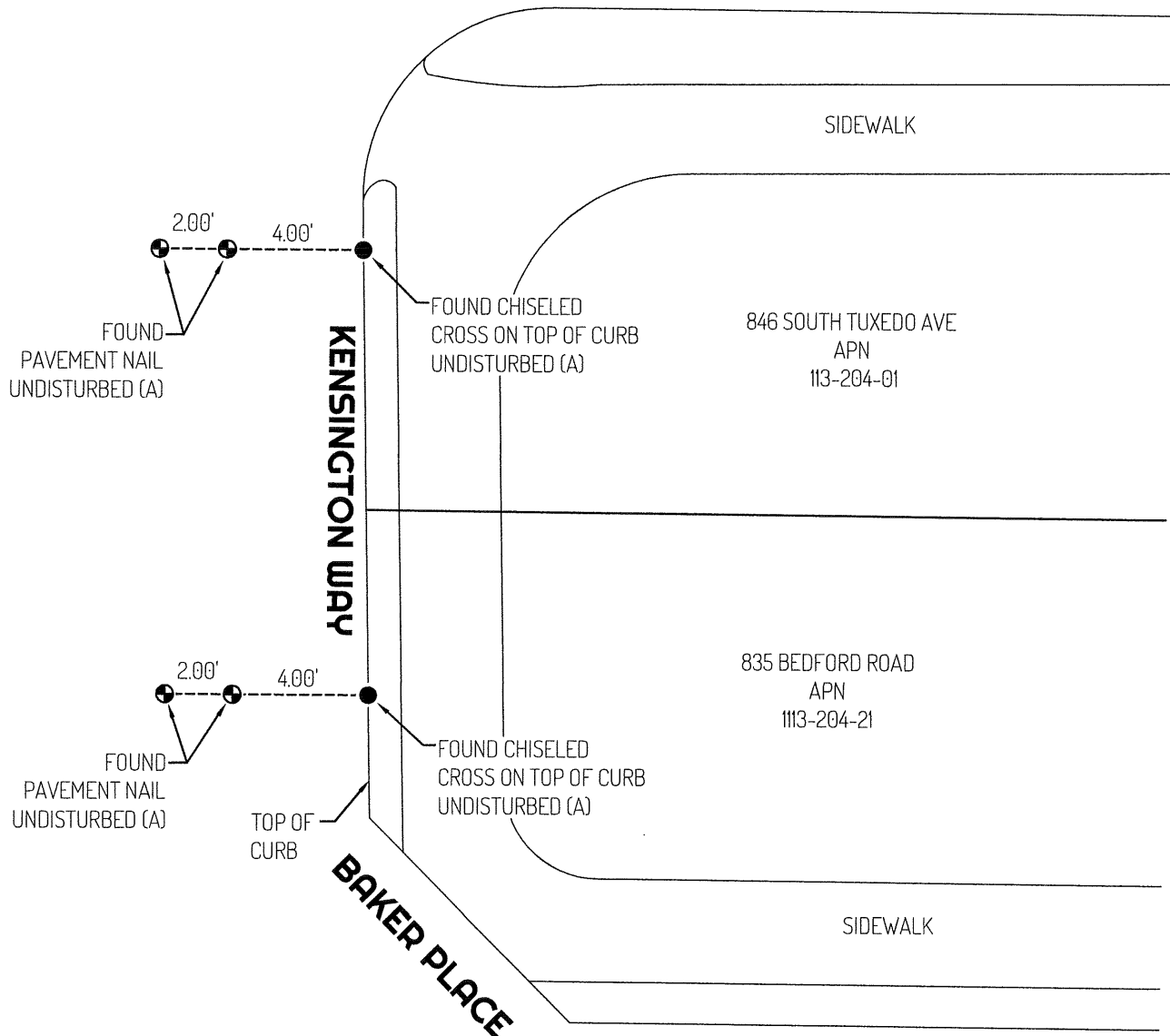

LEGEND

- FOUND CHISELED CROSS, PER (A)
- ⊕ FOUND PAVEMENT NAIL, PER (A)
- 835 REFERENCE STREET ADDRESS
- APN ASSESSOR'S PARCEL NUMBER

LINETYPE

- TOP OF CURB
- PROPERTY LINE
- TIE LINE

REFERENCES

- (A) CORNER RECORD 22-230, SAN JOAQUIN COUNTY SURVEYOR'S RECORDS

BEDFORD ROAD

