

CORNER RECORD

Agency Index CR-24-248

Document Number _____

City of Stockton County of San Joaquin, California

Brief Legal Description Intersection of Airport Way & Industrial Drive

CORNER TYPE

COORDINATES (Optional)

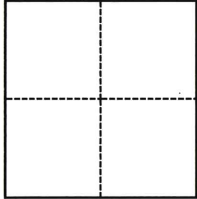

- Government Corner
- Meander
- Rancho
- Control
- Property
- Other

Date of Survey April 17, 2024

N. _____ E. _____

Elevation _____

Units Metric U.S. Survey Foot

Horizontal Datum _____

Zone _____ Epoch Date _____

Vertical Datum _____

Complies with Public Resources Code §§8801-8819

Complies with Public Resources Code §§8890-8902

PLS Act Ref.: 8765(d) 8771 8773 Other:

Corner/Monument: Left as found Established Rebuilt Pre-Construction

Found and tagged Reestablished Referenced Post-Construction

Narrative of corner identified and monument as found, set, reset, replaced, or removed:

See sheet #2 for description(s):

SURVEYOR'S STATEMENT

This Corner Record was prepared by me or under my direction in conformance with

the Professional Land Surveyors' Act on June 20, 2024

Signed [Signature] P.L.S. or R.C.E. No. 8080



COUNTY SURVEYOR'S STATEMENT

This Corner Record was received June 25, 2024

and examined and filed July 11, 2024

Signed James E Hart P.L.S. or R.C.E. No. 8657

Title County Surveyor

County Surveyor's Comment



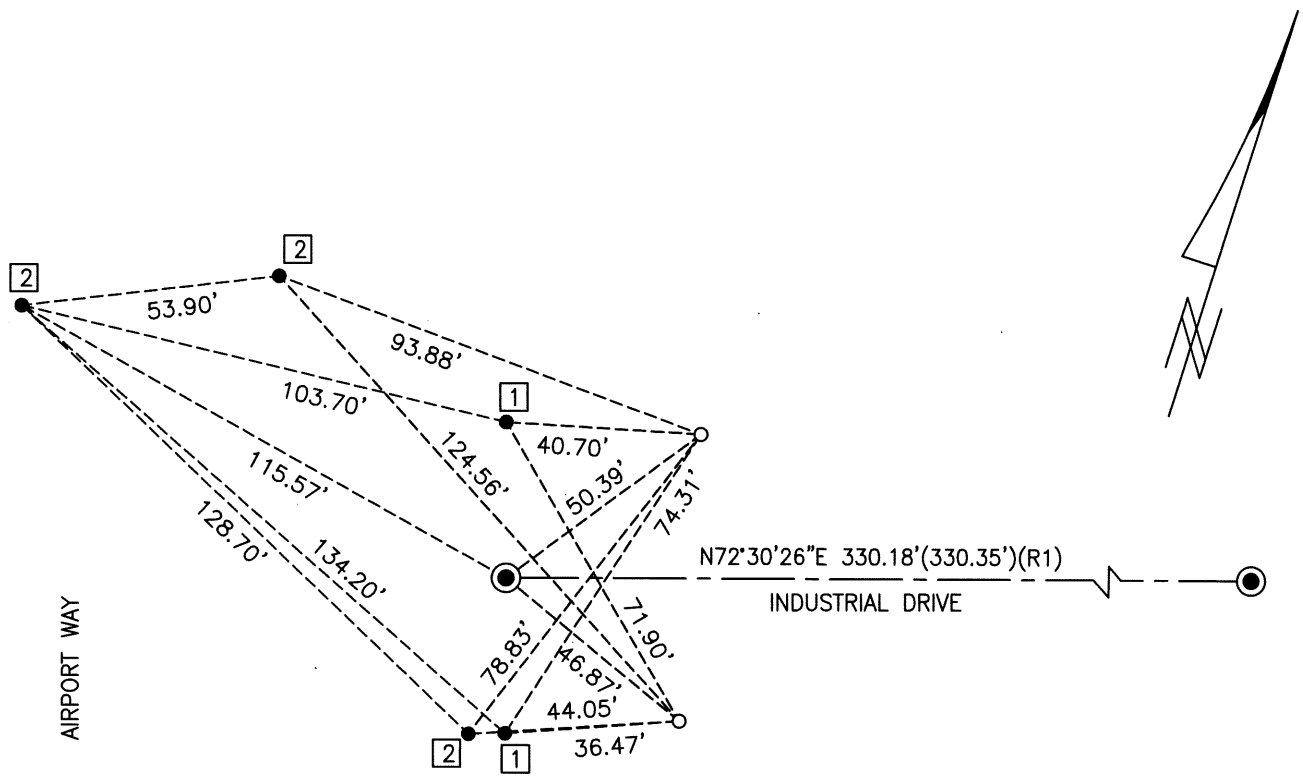

FOUND MONUMENT TABLE:

- 1 FOUND CHISELED CROSS, NO REFERENCE
- 2 FOUND MAG NAIL & WASHER STAMPED "BKF SURVEY PLS 6868", NO REFERENCE

LEGEND:

- S.J.C.R. SAN JOAQUIN COUNTY RECORDS
- M.&P. MAPS & PLATS, VOLUME - PAGE, S.J.C.R.
- FOUND MONUMENT AS NOTED
- SET MAG NAIL AND BRASS WASHER STAMPED "PLS8080"
- ⊙ FOUND 3/4" IRON PIN CAPPED "L.S. 3108" IN MONUMENT WELL PER (R1)

REFERENCES:

(R1) M.&P. 31-68, S.J.C.R.

BASIS OF BEARINGS:

THE CENTER LINE OF INDUSTRIAL DRIVE AS SHOWN ON M.&P. 31-68, BEING N72°30'26"E.